

# BALL VALVES

## Model BV835 Ball Valve

The Model BV835 Ball Valve is capable of a working pressure of 1,000 P.S.I. in sizes 2", 2 1/2", and 3". Flow may be from either direction and the valves may be positioned in any orientation. The Model BV835 is furnished with grooved ends and features a handle that accepts a padlock device for locking in either the open or closed position.



Tech Data: G380

Valve Size Inches <i>mm</i>	Pipe O.D. Inches <i>mm</i>	Nominal Size			Approx. Weight lbs. <i>Kgs</i>
		A Inches <i>mm</i>	B Inches <i>mm</i>	C Inches <i>mm</i>	
2" 50	2.375 60.3	5.50 140.0	3.75 95.0	7.00 178.0	6.9 3.1
2 1/2" 65	2.875 73.0	6.25 159.0	5.20 132.0	10.43 265.0	13.0 5.9
3" 80	3.500 88.9	6.56 167.0	5.63 143.0	10.43 265.0	27.5 12.5

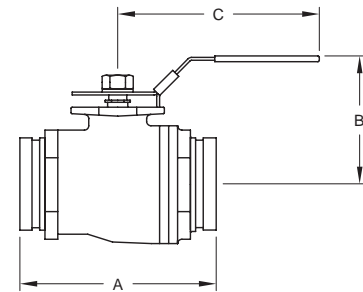

VALVES

## MATERIAL SPECIFICATIONS

### Body

- Ductile iron conforming to ASTM A-536, Grade 65-45-12

### Body Coating

Black Enamel

### Ball

304SS

### Ball Seal

Teflon

### Upper Stem

Carbon Steel Nickel Plated

### Operator

Lever with locking device

## Performance

