

# FLANGES

## Figure 71 Flange Adapter (ANSI Class 125/150)

The Figure 71 Flange Adapter is capable of pressures up to 300 psig (20.7 Bar) depending on pipe size and wall thickness. It provides a direct transition from flanged components into a grooved piping system. I.P.S. size flange bolt patterns conform to ANSI Class 125 and 150.

The gasket seal is designed with optimum amount of rubber to provide a dependable seal and also avoid the overfilling of the gasket pocket which may cause assembly difficulties.

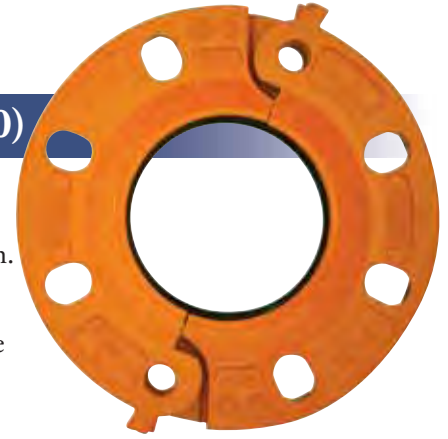

Tech Data: G150

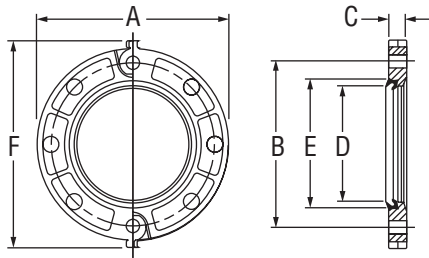

For Fire Protection Pressure Rating and Listing / Approval information contact Tyco Fire & Building Products.

| Nominal Size<br>Inches<br>mm | Pipe OD<br>Inches<br>mm | Max.†<br>Pressures<br>psi<br>Bar | Max. End†<br>Load<br>Lbs.<br>kN | Nominal Dimensions |                   |                   |                    |                    |                   | Bolts** |                      | Approx.<br>Weight<br>Lbs.<br>Kg |
|------------------------------|-------------------------|----------------------------------|---------------------------------|--------------------|-------------------|-------------------|--------------------|--------------------|-------------------|---------|----------------------|---------------------------------|
|                              |                         |                                  |                                 | A<br>Inches<br>mm  | B<br>Inches<br>mm | C<br>Inches<br>mm | D*<br>Inches<br>mm | E*<br>Inches<br>mm | F<br>Inches<br>mm | Qty     | Size<br>Inches<br>mm |                                 |
| 2<br>50                      | 2.375<br>60.3           | 300<br>20.7                      | 1,329.0<br>5.91                 | 6.38<br>162.1      | 4.75<br>120.7     | 0.75<br>19.1      | 2.38<br>60.5       | 3.41<br>86.6       | 7.25<br>184.2     | 4       | 5/8 x 3              | 3.0<br>1.4                      |
| 2½<br>65                     | 2.875<br>73.0           | 300<br>20.7                      | 1,947.5<br>8.66                 | 7.00<br>178.0      | 5.50<br>140.0     | 0.88<br>22.0      | 2.88<br>73.0       | 3.91<br>99.0       | 7.88<br>200.0     | 4       | 5/8 x 3              | 5.0<br>2.3                      |
| 3<br>80                      | 3.500<br>88.9           | 300<br>20.7                      | 2,886.3<br>12.84                | 7.50<br>190.5      | 6.00<br>152.4     | 0.94<br>23.9      | 3.50<br>88.9       | 4.53<br>115.1      | 9.88<br>251.0     | 4       | 5/8 x 3              | 5.6<br>2.5                      |
| 4<br>100                     | 4.500<br>114.3          | 300<br>20.7                      | 4,771.3<br>21.22                | 9.00<br>228.6      | 7.50<br>190.5     | 0.94<br>23.9      | 4.50<br>114.3      | 5.53<br>140.5      | 9.90<br>251.5     | 8       | 5/8 x 3              | 7.0<br>3.2                      |
| 5<br>125                     | 5.563<br>141.3          | 300<br>20.7                      | 7,291.7<br>32.44                | 10.00<br>254.0     | 8.50<br>215.9     | 1.00<br>25.4      | 5.56<br>141.2      | 6.72<br>170.7      | 11.38<br>289.1    | 8       | ¾ x 3½               | 9.2<br>4.2                      |
| 6<br>150                     | 6.625<br>168.3          | 300<br>20.7                      | 10,341.5<br>46.02               | 11.00<br>279.4     | 9.50<br>241.3     | 1.00<br>25.4      | 6.62<br>168.1      | 7.78<br>197.6      | 11.88<br>301.8    | 8       | ¾ x 3½               | 10.0<br>4.5                     |
| 8<br>200                     | 8.625<br>219.1          | 300<br>20.7                      | 17,527.9<br>77.99               | 13.50<br>342.9     | 11.75<br>298.5    | 1.13<br>28.7      | 8.62<br>218.9      | 9.94<br>252.5      | 14.36<br>365.3    | 8       | ¾ x 3½               | 16.6<br>7.5                     |
| 10<br>250                    | 10.750<br>273.0         | 300<br>20.7                      | 27,228.8<br>121.08              | 16.00<br>406.4     | 14.25<br>362.0    | 1.19<br>30.2      | 10.75<br>273.1     | 12.31<br>312.7     | 16.88<br>428.8    | 12      | 7/8 x 4              | 21.8<br>9.9                     |
| 12<br>300                    | 12.750<br>323.9         | 300<br>20.7                      | 38,302.9<br>170.44              | 19.00<br>482.6     | 17.00<br>431.8    | 1.25<br>31.8      | 12.75<br>323.9     | 14.31<br>363.9     | 20.00<br>508.0    | 12      | 7/8 x 4              | 24.2<br>11.0                    |

† Maximum pressure and end load are total from all loads based on standard weight steel pipe. Pressure ratings and end loads may differ on other pipe materials and/or wall thickness. Contact Tyco Fire & Building Products for details.

\* Dimensions D and E represent minimum and maximum sealing surfaces.

\*\* Bolts are not supplied. Bolt lengths shown are standard; it is the responsibility of the purchaser to verify correct length for the intended application.

Note: Metal flange washer adapters are required when the Figure 71 Flange Adapter is used against surfaces such as:

- Rubber surfaces
- Adapting to AWWA cast flanges
- Rubber faced wafer valves
- Serrated flange surfaces

Figure 71 Flange Adapters are not recommended for applications which incorporate tie rods for anchoring or on a standard fitting within 90° of each other. Contact Tyco Fire & Building Products for recommendations prior to using with plastic pipe.

Please refer to General Notes on page 14.

# FLANGES

## Flange Washer Adapter

Material: Stainless Steel ASTM A666 Type 304-2B

GROOVED  
COUPLINGS  
& FITTINGS

| Nominal Size<br>Inches<br><i>mm</i> | Pipe OD<br>Inches<br><i>mm</i> | Nominal Dimensions       |                          |
|-------------------------------------|--------------------------------|--------------------------|--------------------------|
|                                     |                                | A<br>Inches<br><i>mm</i> | B<br>Inches<br><i>mm</i> |
| †2<br>50                            | 2.375<br>60.3                  | 3.94<br>100.0            | 2.75<br>69.9             |
| ‡2½<br>65                           | 2.875<br>73.0                  | 4.69<br>119.1            | 2.75<br>69.9             |
| *                                   | 3.000<br>76.1                  | 4.89<br>124.2            | 2.88<br>73.2             |
| ‡                                   | 3.500<br>88.9                  | 5.19<br>131.8            | 3.38<br>85.9             |
| *3<br>80                            | 3.500<br>88.9                  | 5.48<br>139.2            | 3.38<br>85.9             |
| ‡4<br>100                           | 4.500<br>114.3                 | 6.69<br>169.9            | 4.38<br>111.3            |
| *4<br>100                           | 4.500<br>114.3                 | 6.27<br>159.3            | 4.38<br>111.3            |
| ‡5<br>125                           | 5.563<br>141.3                 | 7.56<br>192.0            | 5.38<br>136.7            |
| *                                   | 5.500<br>139.7                 | 7.45<br>189.2            | 5.32<br>135.1            |
| *                                   | 6.500<br>165.1                 | 8.47<br>215.1            | 6.32<br>160.5            |
| †6<br>150                           | 6.625<br>168.3                 | 8.56<br>217.4            | 6.44<br>163.6            |
| ‡8<br>200                           | 8.625<br>219.1                 | 10.81<br>274.6           | 8.44<br>214.4            |
| *8<br>200                           | 8.625<br>219.1                 | 10.64<br>270.3           | 8.44<br>214.4            |
| ‡10<br>250                          | 10.750<br>273.0                | 13.19<br>335.0           | 10.50<br>266.7           |
| *10<br>250                          | 10.750<br>273.0                | 12.85<br>326.4           | 10.50<br>266.7           |
| ‡12<br>300                          | 12.750<br>323.9                | 15.94<br>404.9           | 12.50<br>317.5           |
| *12<br>300                          | 12.750<br>323.9                | 15.01<br>381.3           | 12.50<br>317.5           |

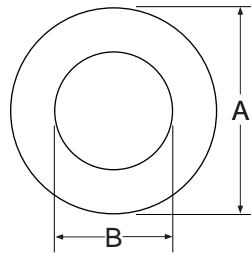

\* DIN

† DIN and ANSI

‡ ANSI

Note: Metal flange washer adapters are required when the Figure 71

Flange Adapter is used against surfaces such as:

- Rubber surfaces
- Adapting to AWWA cast flanges
- Rubber faced wafer valves
- Serrated flange surfaces

Please refer to General Notes on page 14.